

SILENCER CATALOG



YOUR EXHAUST SYSTEM COMPONENTS SOLUTION



For products not included in the catalog, please contact us for a quote.

Rev030421-A



Manufacturer of the Year



ISO 9001:2015 Certified

inExhaust has over 50 years' combined experience in exhaust system manufacturing, power generation, emissions, and the oil and gas industries. Innovative Exhaust Solutions, Inc was established in 2016 by Juan Breucop and Mike Rodriguez.

CONTACT



402-322-7022



402-322-7032



Sales@inExhaust.com



4010 NW 39th Street | Lincoln, NE | 68524 | USA



www.inExhaust.com

All dimensions are in inches. All weights are approximate and in pounds.

*Special items are not refundable. All catalog items are standard sizing. Call factory for pricing on non-standard items.
Contents subject to change without notice. Minimum order amount \$50.*

©2016-2021 Innovative Exhaust Solutions, Inc. Lincoln, NE USA
Unauthorized reproduction in full or part is strictly prohibited. | Rev030220-D



Silencer Family/Series	Page
Part Number Schema	4
Slim Series	
Critical Grade	
600C (No Packing)	5
601C (1" Packing)	6
602C (2" Packing)	7
Hospital Grade	
601H (1" Packing)	8
602H (2" Packing)	9
Extreme Grade	
601E (1" Packing)	10
602E (2" Packing)	11
Disk Series	
Residential Grade	
700R (No Packing)	12
701R (1" Packing)	13
Critical Grade	
700C (No Packing)	14
701C (1" Packing)	15
702C (2" Packing)	16
Hospital Grade	
701H (1" Packing)	17
702H (2" Packing)	18
Spark Arresting	
Residential Grade	
701SAR (1" Packing)	19
Critical Grade	
701SAC (1" Packing)	20
Compact Series	
Residential Grade	
800R	21

Silencer Family/Series	Page
Compact Series (continued)	
Critical Grade	
800C	22
Hospital Grade	
800H	23
Cylindrical Series	
Industrial Grade	
900I	24
Residential Grade	
900R	25
Critical Grade	
900C	26
Hospital Grade	
900H	27
Extreme Grade	
900E Extreme Grade	28
Spark Arresting	
Residential Grade	
90SAR	29
Critical Grade	
90SAC	30
Hospital Grade	
90SAH	31
Industrial Grade	
90SAI	32
Silencer Mounting Bracket Options	33
Explosion Relief Cover Kits	34
Silencer Install Guide	35
Terms & Conditions	38
Standard Warranty	40

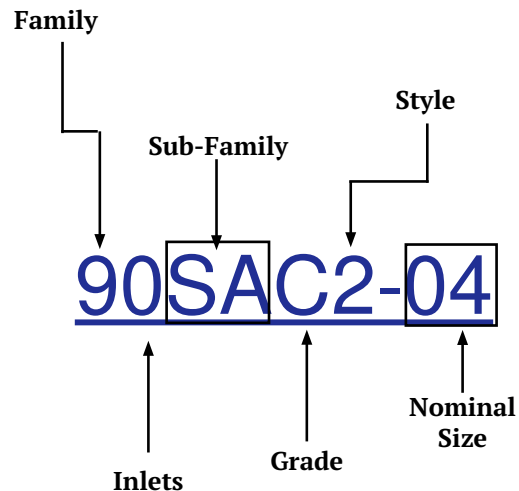
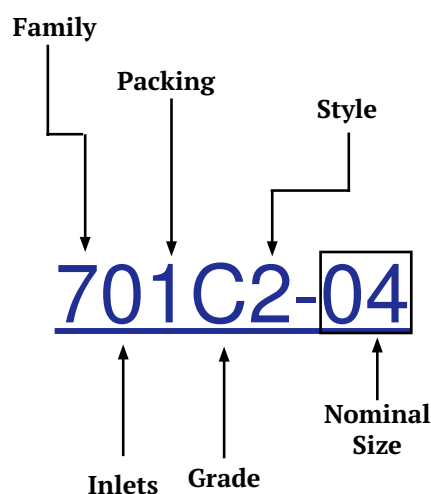

OPTIONS

SCHEMA	AVAILABLE OPTIONS
Family/Series	Slim (600s), Disk (700s), Compact (800s), Cylindrical (900s)
Inlets	0 (Single Inlet), 2 (Dual Inlets)
Packing	0 (No Packing), 1 (1" Packing), 2 (2" Packing)
Sub-Family	SA (Spark Arresting)
Grade	R (Residential), C (Critical), H (Hospital), E (Extreme)
Style	1 (End-in/End Out), 2 (Side in/End Out), 3 (Side in/Side out)
Nominal Size	Size in inches. (example: 04 equals 4 inches)
Brackets	N (No Brackets), T (Top Brackets), B (Bottom Brackets)

ABBREVIATIONS	
OAL	Overall Length
Dims	Dimensions
WT	Weight
DIA	Diameter



CRITICAL GRADE 600C

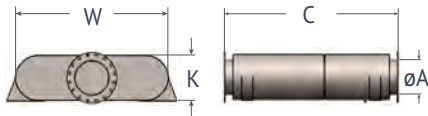

STYLE 1

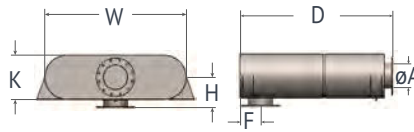

STYLE 2

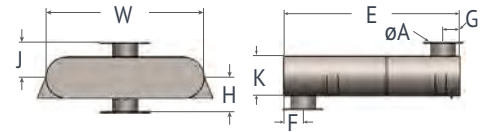

STYLE 3

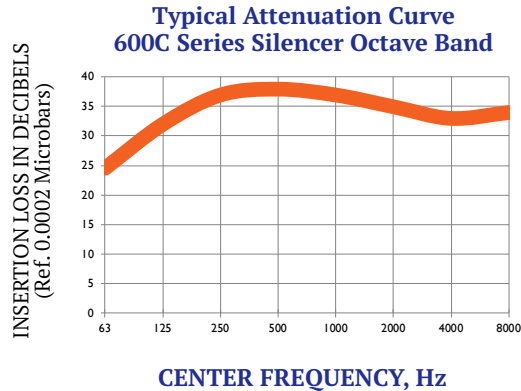

APPLICATION

- Engineered to provide a high degree of attenuation in a low, space-saving design.
- Good where noise level requirements are relatively low.
- Excellent for any application where size restriction is a critical factor.
- Ideal for use where heat loss is not a critical factor.
- Typical Attenuation: 31 to 38 dBA

STANDARD BUILD

- Internally unpacked silencer.
- High heat black finish.
- Bottom mounting brackets.
- Fully-welded, heavy-duty carbon steel.

600C Dimensions (inches)

PART NUMBER	A OUTLET	K HEIGHT	W WIDTH	C OAL	D OAL	E OAL	F MIN	F MAX	G MIN	H/J Dims	WT
600C2-04	4	9	26	34	30	26	5	8	5	8.5	105
600C2-05	5	10	28	35	31	27	6	17	6	9.0	140
600C2-06	6	11	32	39	35	31	6	16	6	9.5	190
600C2-08	8	13	42	52	48	44	7	23	7	10.5	355
600C2-10	10	16	50	58	54	50	8	26	8	12.0	515
600C2-12	12	19	60	68	64	60	9	32	9	13.5	720
600C2-14	14	21	62	72	68	64	10	34	10	14.5	860
600C2-16	16	23	72	81	77	73	11	38	11	15.5	1,195
600C2-18	18	25	82	92	88	84	12	45	12	16.5	1,460
600C2-20	20	28	86	96	92	88	14	46	14	18.0	1,775

CRITICAL GRADE OPTIONS

Available in three options: 600C (No internal packing), 601C (1" internal packing), 602C (2" internal packing).

CONNECTION OPTIONS

Standard Connections	125/150# ANSI Pattern flanged inlet and outlet. Side inlet, end outlet. (Style 2)
Flush Mount Option	Flush mount inlet good for applications where space is extremely limited.*
Other Options	Flanged connections can be replaced with ID cuff, OD tube, NPT, etc.*

ADDITIONAL OPTIONS

- Mounting brackets can be removed or top mounted.
- Leak testing – per request, fee applicable
- Stainless steel *

*Contact factory for details.

CRITICAL GRADE 601C

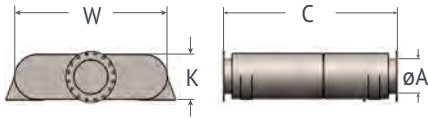

STYLE 1

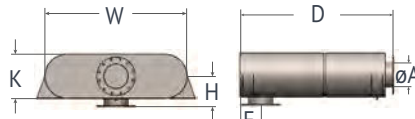

STYLE 2

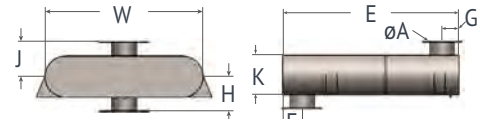

STYLE 3

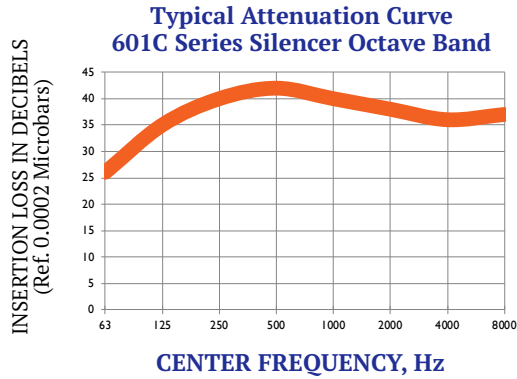

APPLICATION

- Engineered to provide a high degree of attenuation in a low, space-saving design.
- Ideal for enclosures or restricted areas where heat is critical.
- 1" thick packed shell design provides significant reduction of outer surface temp. *Actual values depend on exhaust temp, ambient conditions and run time.*
- Typical Attenuation: 34 to 40 dBA

STANDARD BUILD

- Features compressed thermal/acoustical fiberglass packed shell.
- High heat black finish.
- Bottom mounting brackets.
- Fully-welded, heavy-duty carbon steel.

601C Dimensions (inches)

PART NUMBER	A OUTLET	K HEIGHT	W WIDTH	C OAL	D OAL	E OAL	F MIN	F MAX	G MIN	H/J Dims	WT
601C2-04	4	10	26	34	30	26	5	15	5	9	125
601C2-05	5	10	27	35	31	27	6	15	6	9	150
601C2-06	6	12	31	39	35	31	6	16	6	10	225
601C2-08	8	14	43	52	48	44	7	23	7	11	395
601C2-10	10	16	50	58	54	50	8	26	8	12	550
601C2-12	12	20	60	68	64	60	9	32	9	14	780
601C2-14	14	22	63	72	68	64	10	34	10	15	945
601C2-16	16	24	72	81	77	73	11	38	11	16	1,305
601C2-18	18	26	82	92	88	84	12	45	12	17	1,590
601C2-20	20	28	86	96	92	88	14	46	14	18	1,905

CRITICAL GRADE OPTIONS

Available in three options: 600C (No internal packing), 601C (1" internal packing), 602C (2" internal packing).

CONNECTION OPTIONS

Standard Connections	125/150# ANSI Pattern flanged inlet and outlet. Side inlet, end outlet. (Style 2)
Flush Mount Option	Flush mount inlet good for applications where space is extremely limited. *
Other Options	Flanged connections can be replaced with ID cuff, OD tube, NPT, etc. *

ADDITIONAL OPTIONS

- Mounting brackets can be removed or top mounted.
- Leak testing – per request, fee applicable
- Stainless steel *

*Contact factory for details.



CRITICAL GRADE 602C

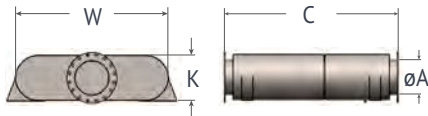

STYLE 1

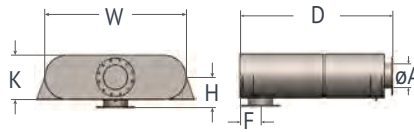

STYLE 2

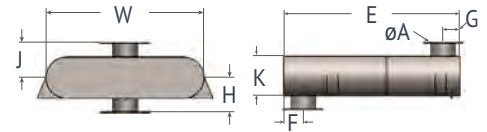

STYLE 3

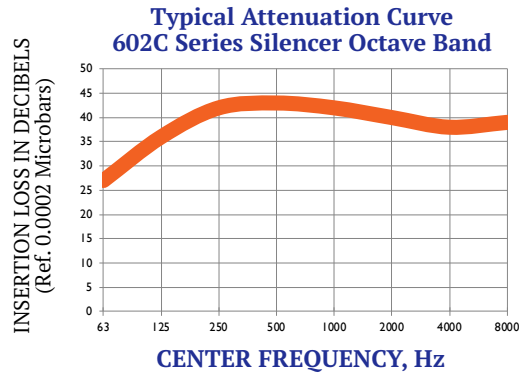

APPLICATION

- Engineered to provide a high degree of attenuation in a low, space-saving design.
- Ideal for enclosures or restricted areas where heat is critical.
- 2" thick packed shell design provides significant reduction of outer surface temp. *Actual values depend on exhaust temp, ambient conditions and run time.*
- Typical Attenuation: 35 to 42 dBA

STANDARD BUILD

- Features compressed thermal/acoustical fiberglass packed shell.
- High heat black finish.
- Bottom mounting brackets.
- Fully-welded, heavy-duty carbon steel.

602C Dimensions (inches)

PART NUMBER	A OUTLET	K HEIGHT	W WIDTH	C OAL	D OAL	E OAL	F MIN	F MAX	G MIN	H/J Dims	WT
602C2-04	4	12	28	36	32	28	6	15	6	8.5	135
602C2-05	5	12	29	37	33	29	6	15	6	9.0	165
602C2-06	6	14	33	41	37	33	7	17	7	9.5	245
602C2-08	8	16	45	54	50	46	8	24	8	10.5	425
602C2-10	10	18	52	60	56	52	9	27	9	12.0	605
602C2-12	12	22	62	70	66	62	10	33	10	13.5	850
602C2-14	14	24	65	74	70	66	11	34	11	14.5	1,024
602C2-16	16	26	74	83	79	75	12	39	12	15.5	1,365
602C2-18	18	28	84	94	90	86	14	46	14	16.5	1,750
602C2-20	20	30	88	98	94	90	15	47	15	18.0	2,055

CRITICAL GRADE OPTIONS

Available in three options: 600C (No internal packing), 601C (1" internal packing), 602C (2" internal packing).

CONNECTION OPTIONS

Standard Connections	125/150# ANSI Pattern flanged inlet and outlet. Side inlet, end outlet. (Style 2)
Flush Mount Option	Flush mount inlet good for applications where space is extremely limited. *
Other Options	Flanged connections can be replaced with ID cuff, OD tube, NPT, etc. *

ADDITIONAL OPTIONS

- Mounting brackets can be removed or top mounted.
- Leak testing – per request, fee applicable
- Stainless steel *

*Contact factory for details.

HOSPITAL GRADE 601H

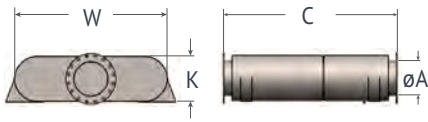

STYLE 1

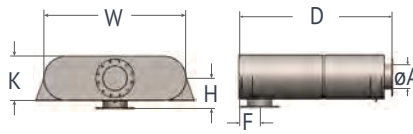

STYLE 2

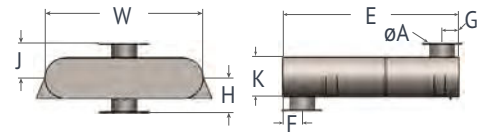

STYLE 3

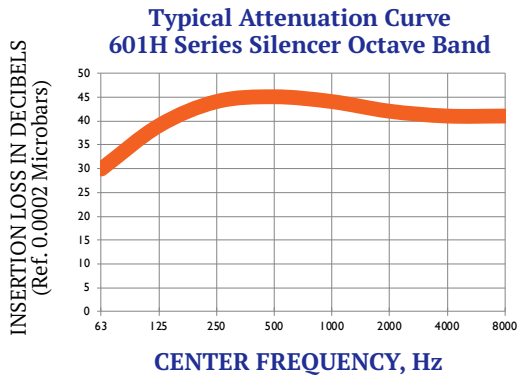

APPLICATION

- Engineered to provide a high degree of attenuation in a low, space-saving design.
- Ideal where ambient noise level requirements are very low and/or where size restriction is a critical factor.
- 1" thick packed shell design provides significant reduction of outer surface temp. *Actual values depend on exhaust temp, ambient conditions and run time.*
- Typical Attenuation: 37 to 44 dBA

STANDARD BUILD

- Features compressed thermal/acoustical fiberglass packed shell.
- High heat black finish.
- Bottom mounting brackets.
- Fully-welded, heavy-duty carbon steel.

601H Dimensions (inches)

PART NUMBER	A OUTLET	K HEIGHT	W WIDTH	C OAL	D OAL	E OAL	F MIN	F MAX	G MIN	H/J DIMS	WT
601H2-04	4	10	32	40	36	32	5	15	5	6.5	185
601H2-05	5	10	34	40	36	32	6	18	6	6.5	215
601H2-06	6	12	36	44	40	36	6	20	6	10	275
601H2-08	8	14	50	58	54	50	7	27	7	11	575
601H2-10	10	16	57	65	61	57	8	31	8	12	690
601H2-12	12	20	68	76	72	68	9	37	9	14	1,065
601H2-14	14	22	68	76	72	68	10	36	10	15	1,220
601H2-16	16	26	73	82	78	74	11	39	11	17	1,450
601H2-18	18	28	84	94	90	86	12	45	13	18	1,875
601H2-20	20	32	90	100	96	92	14	47	14	20	2,220

HOSPITAL GRADE OPTIONS

Available in two options: 601H (1" internal packing), 602H (2" internal packing).

CONNECTION OPTIONS

Standard Connections	125/150# ANSI Pattern flanged inlet and outlet. Side inlet, end outlet. (Style 2)
Flush Mount Option	Flush mount inlet good for applications where space is extremely limited. *
Other Options	Flanged connections can be replaced with ID cuff, OD tube, NPT, etc. *

ADDITIONAL OPTIONS

- Mounting brackets can be removed or top mounted.
- Leak testing – per request, fee applicable
- Stainless steel *



HOSPITAL GRADE 602H

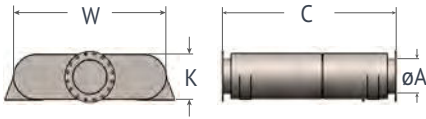

STYLE 1

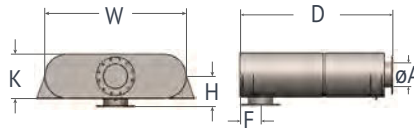

STYLE 2

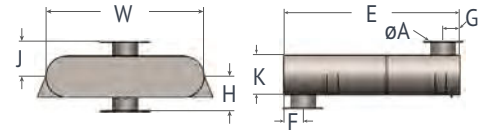

STYLE 3

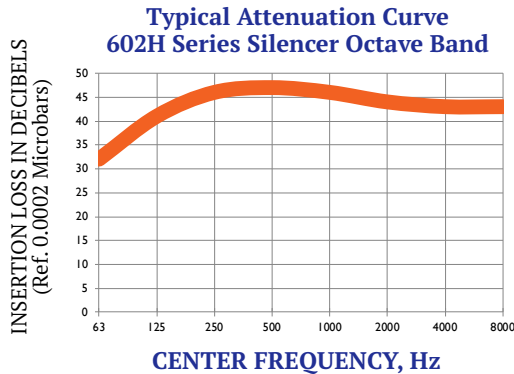

APPLICATION

- Engineered to provide a high degree of attenuation in a low, space-saving design.
- Ideal where ambient noise level requirements are very low and/or where size restriction is a critical factor.
- 2" thick packed shell design provides significant reduction of outer surface temp. *Actual values depend on exhaust temp, ambient conditions and run time.*
- Typical Attenuation: 39 to 46 dBA

STANDARD BUILD

- Features compressed thermal/acoustical fiberglass packed shell.
- High heat black finish.
- Bottom mounting brackets.
- Fully-welded, heavy-duty carbon steel.

602H Dimensions (inches)

PART NUMBER	A OUTLET	K HEIGHT	W WIDTH	C OAL	D OAL	E OAL	F MIN	F MAX	G MIN	H/J DIMS	WT
602H2-04	4	12	34	42	38	34	6	16	6	10	195
602H2-05	5	12	34	42	38	34	7	19	7	10	215
602H2-06	6	14	38	46	42	38	7	21	7	11	295
602H2-08	8	16	53	60	56	52	8	28	8	12	575
602H2-10	10	18	59	67	63	59	9	32	9	13	790
602H2-12	12	22	70	78	74	70	10	38	10	15	1,140
602H2-14	14	24	70	78	74	70	11	37	11	16	1,445
602H2-16	16	28	75	84	80	76	12	40	12	18	1,750
602H2-18	18	30	86	96	92	88	14	47	14	19	1,930
602H2-20	20	34	92	102	98	94	15	48	15	21	2,260

HOSPITAL GRADE OPTIONS

Available in two options: 601H (1" internal packing), 602H (2" internal packing).

CONNECTION OPTIONS

Standard Connections	125/150# ANSI Pattern flanged inlet and outlet. Side inlet, end outlet. (Style 2)
Flush Mount Option	Flush mount inlet good for applications where space is extremely limited. *
Other Options	Flanged connections can be replaced with ID cuff, OD tube, NPT, etc. *

ADDITIONAL OPTIONS

- Mounting brackets can be removed or top mounted.
- Leak testing – per request, fee applicable
- Stainless steel *

EXTREME GRADE 601E



STYLE 1



STYLE 2

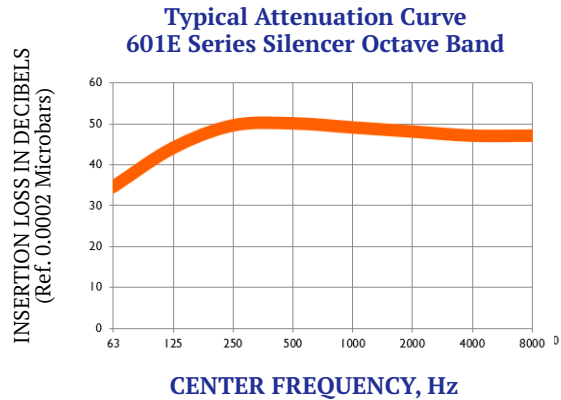

APPLICATION

- Engineered to provide a high degree of attenuation in a low, space-saving design.
- Ideal where ambient noise level requirements are very low and/or where size restriction is a critical factor.
- 1" thick packed shell design provides significant reduction of outer surface temp.
Actual values depend on exhaust temp, ambient conditions and run time.
- Typical Attenuation: 43 to 50 dBA

STANDARD BUILD

- Features compressed thermal/acoustical fiberglass packed shell.
- High heat black finish.
- Bottom mounting brackets.
- Fully-welded, heavy-duty carbon steel.

601E Dimensions (inches)

PART NUMBER	A OUTLET
601E2-04	4
601E2-05	5
601E2-06	6
601E2-08	8
601E2-10	10
601E2-12	12
601E2-14	14
601E2-16	16
601E2-18	18
601E2-20	20

Please contact us for specifications and pricing.

Sales@inExhaust.com or 402-322-7022

EXTREME GRADE OPTIONS

Available in two options: 601E (1" internal packing), 602E (2" internal packing).

CONNECTION OPTIONS

Standard Connections	125/150# ANSI Pattern flanged inlet and outlet. Side inlet, end outlet. (Style 2)
Flush Mount Option	Flush mount inlet good for applications where space is extremely limited.*
Other Options	Flanged connections can be replaced with ID cuff, OD tube, NPT, etc.*

ADDITIONAL OPTIONS

- Mounting brackets can be removed or top mounted.
- Leak testing – per request, fee applicable
- Stainless steel *

*Contact factory for details.



EXTREME GRADE 602E



STYLE 1



STYLE 2

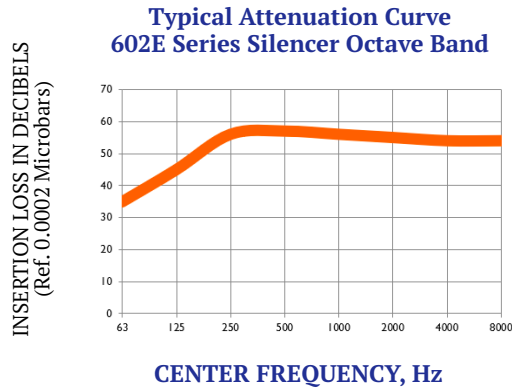

APPLICATION

- Engineered to provide a high degree of attenuation in a low, space-saving design.
- Ideal where ambient noise level requirements are very low and/or where size restriction is a critical factor.
- 2" thick packed shell design provides significant reduction of outer surface temp. *Actual values depend on exhaust temp, ambient conditions and run time.*
- Typical Attenuation: 45 to 52 dBA

STANDARD BUILD

- Features compressed thermal/acoustical fiberglass packed shell.
- High heat black finish.
- Bottom mounting brackets.
- Fully-welded, heavy-duty carbon steel.

602E Dimensions (inches)

PART NUMBER	A OUTLET
602E2-04	4
602E2-05	5
602E2-06	6
602E2-08	8
602E2-10	10
602E2-12	12
602E2-14	14
602E2-16	16
602E2-18	18
602E2-20	20

Please contact us for specifications and pricing.

Sales@inExhaust.com or 402-322-7022

EXTREME GRADE OPTIONS

Available in two options: 601E (1" internal packing), 602E (2" internal packing).

CONNECTION OPTIONS

Standard Connections	125/150# ANSI Pattern flanged inlet and outlet. Side inlet, end outlet. (Style 2)
Flush Mount Option	Flush mount inlet good for applications where space is extremely limited. *
Other Options	Flanged connections can be replaced with ID cuff, OD tube, NPT, etc. *

ADDITIONAL OPTIONS

- Mounting brackets can be removed or top mounted.
- Leak testing – per request, fee applicable
- Stainless steel *

*Contact factory for details.

RESIDENTIAL GRADE 700R

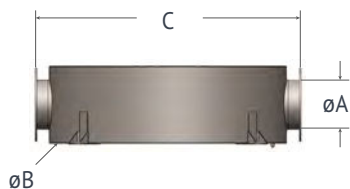

STYLE 1

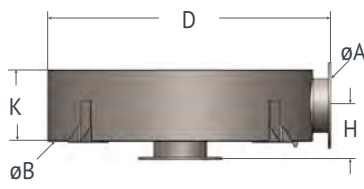

STYLE 2

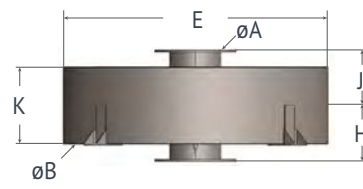

STYLE 3

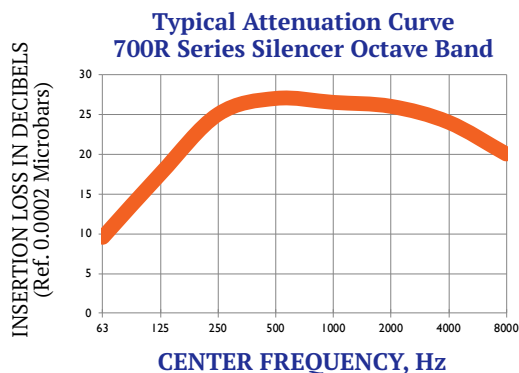

APPLICATION

- Engineered for applications where ambient noise level requirements are moderate.
- Good for use in enclosures, trailers, marine or any other application where size restriction is a critical factor and/or where heat loss is not a critical factor.
- Typical Attenuation: 19 to 26 dBA

STANDARD BUILD

- Internally unpacked disk silencer.
- High heat black finish.
- Bottom mounting brackets.
- Fully-welded, heavy-duty carbon steel.

700R Dimensions (inches)

PART NUMBER	A OUTLET	B DIA	K HEIGHT	C OAL	D OAL	E OAL	H/J DIMS	WT
700R2-04	4	20	8	28	24	20	7.5	84
700R2-05	5	22	10	30	26	22	8.0	98
700R2-06	6	24	10	32	28	24	9.0	116
700R2-08	8	32	12	40	36	32	10.0	191
700R2-10	10	38	14	46	42	38	11.0	260
700R2-12	12	45	16	53	49	45	12.0	397
700R2-14	14	50	18	58	54	50	13.0	510
700R2-16	16	58	20	66	62	58	14.0	615
700R2-18	18	62	24	70	66	62	16.0	767

RESIDENTIAL GRADE OPTIONS

Available in two options: 700R (No internal packing), 701R (1" internal packing).

CONNECTION OPTIONS

Standard Connections	125/150# ANSI Pattern flanged inlet and outlet. Side inlet, end outlet. (Style 2)
Flush Mount Option	Flush mount inlet good for applications where space is extremely limited. *
Other Options	Flanged connections can be replaced with ID cuff, OD tube, NPT, etc. *

ADDITIONAL OPTIONS

- Mounting brackets can be removed or top mounted.
- Leak testing – per request, fee applicable
- Stainless steel *

*Contact factory for details.



RESIDENTIAL GRADE 701R

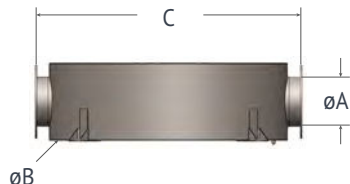

STYLE 1

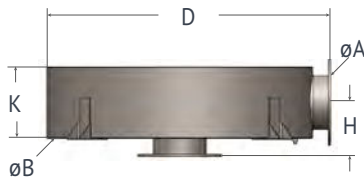

STYLE 2

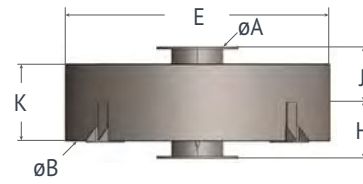

STYLE 3

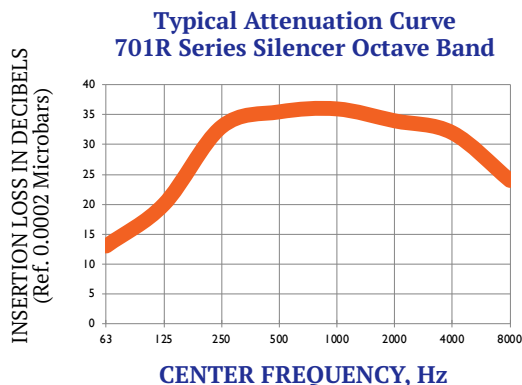

APPLICATION

- Engineered for applications where ambient noise level requirements are moderate.
- Good for use in enclosures, trailers, marine or any other application where size restriction is a critical factor and/or where heat loss is not a critical factor.
- 1" thick packed shell design provides significant reduction of outer surface temp.
Actual values depend on exhaust temp, ambient conditions and run time.
- Typical Attenuation: 22 to 28 dBA

STANDARD BUILD

- Features compressed thermal/acoustical fiberglass packed shell.
- High heat black finish.
- Bottom mounting brackets.
- Fully-welded, heavy-duty carbon steel.

701R Dimensions (inches)

PART NUMBER	A OUTLET	B DIA	K HEIGHT	C OAL	D OAL	E OAL	H/J DIMS	WT
701R2-04	4	22	8	30	26	22	7.5	96
701R2-05	5	24	10	32	28	24	8.0	116
701R2-06	6	26	11	34	30	26	9.5	131
701R2-08	8	34	13	42	38	34	10.5	222
701R2-10	10	40	15	48	44	40	11.5	310
701R2-12	12	47	17	55	51	47	12.5	415
701R2-14	14	52	19	60	56	52	13.0	545
701R2-16	16	60	21	68	64	60	14.5	660
701R2-18	18	64	25	72	68	64	15.5	820

RESIDENTIAL GRADE OPTIONS

Available in two options: 700R (No internal packing), 701R (1" internal packing).

CONNECTION OPTIONS

Standard Connections	125/150# ANSI Pattern flanged inlet and outlet. Side inlet, end outlet. (Style 2)
Flush Mount Option	Flush mount inlet good for applications where space is extremely limited. *
Other Options	Flanged connections can be replaced with ID cuff, OD tube, NPT, etc. *

ADDITIONAL OPTIONS

- Mounting brackets can be removed or top mounted.
- Leak testing – per request, fee applicable
- Stainless steel *

*Contact factory for details.

CRITICAL GRADE 700C

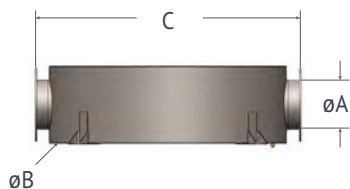

STYLE 1

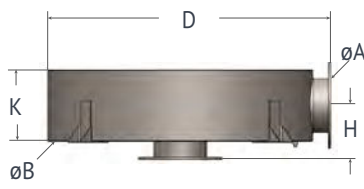

STYLE 2

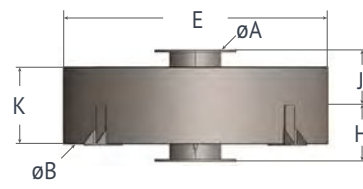

STYLE 3

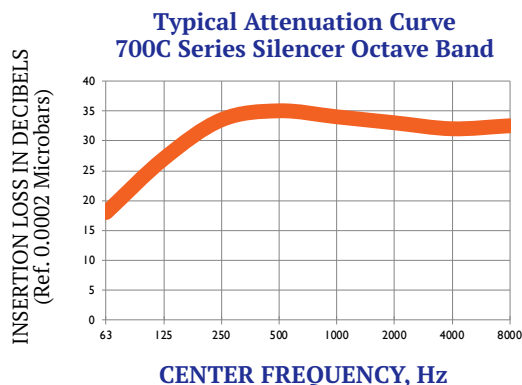

APPLICATION

- Engineered for applications where ambient noise level requirements are moderate.
- Good for use in enclosures, trailers, marine or any other application where size restriction is a critical factor and/or where heat loss is not a critical factor.
- Typical Attenuation: 27 to 31 dBA

STANDARD BUILD

- Internally unpacked disk silencer.
- High heat black finish.
- Bottom mounting brackets.
- Fully-welded, heavy-duty carbon steel.

700C Dimensions (inches)

PART NUMBER	A OUTLET	B DIA	K HEIGHT	C OAL	D OAL	E OAL	H/J DIMS	WT
700C2-04	4	26	8	34	30	26	7.5	102
700C2-05	5	28	10	36	32	28	8.0	132
700C2-06	6	32	10	40	36	32	9.0	176
700C2-08	8	45	12	53	49	45	10.0	332
700C2-10	10	52	14	60	56	52	11.0	481
700C2-12	12	60	16	68	64	60	12.0	662
700C2-14	14	65	20	73	69	65	14.0	800
700C2-16	16	74	22	82	78	74	15.0	1,105
700C2-18	18	84	24	92	88	84	16.0	1,354

CRITICAL GRADE OPTIONS

Available in three options: 700C (No internal packing), 701C (1" internal packing), 702C (2" internal packing).

CONNECTION OPTIONS

Standard Connections	125/150# ANSI Pattern flanged inlet and outlet. Side inlet, end outlet. (Style 2)
Flush Mount Option	Flush mount inlet good for applications where space is extremely limited.*
Other Options	Flanged connections can be replaced with ID cuff, OD tube, NPT, etc.*

ADDITIONAL OPTIONS

- Mounting brackets can be removed or top mounted.
- Leak testing – per request, fee applicable
- Stainless steel *

*Contact factory for details.



CRITICAL GRADE 701C

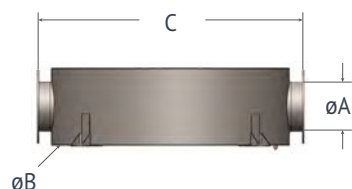

STYLE 1

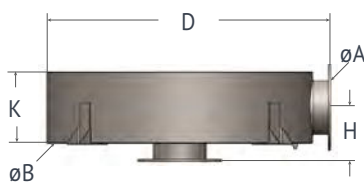

STYLE 2

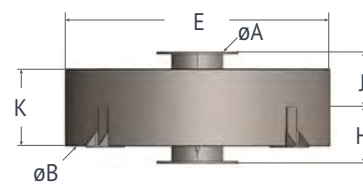

STYLE 3

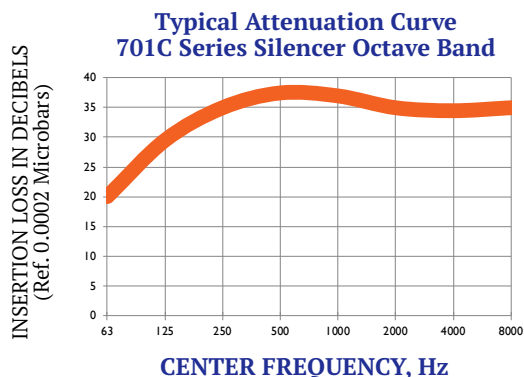

APPLICATION

- Engineered for applications where ambient noise level requirements are moderate.
- Good for use in enclosures, trailers, marine or any other application where size restriction is a critical factor and/or where controlling heat loss is not a critical factor.
- 1" thick packed shell design provides significant reduction of heat loss. *Actual values depend on exhaust temp, ambient conditions and run time.*
- Typical Attenuation: 30 to 34 dBA

STANDARD BUILD

- Features compressed thermal/acoustical fiberglass packed shell.
- High heat black finish.
- Bottom mounting brackets.
- Fully-welded, heavy-duty carbon steel.

701C Dimensions (inches)

PART NUMBER	A OUTLET	B DIA	K HEIGHT	C OAL	D OAL	E OAL	H/J DIMS	WT
701C2-04	4	26	8	34	30	26	7.5	110
701C2-05	5	28	10	36	32	28	8.0	140
701C2-06	6	32	10	40	36	32	9.0	190
701C2-08	8	45	12	53	49	45	10.0	355
701C2-10	10	52	14	60	56	52	11.0	515
701C2-12	12	60	16	68	64	60	12.0	710
701C2-14	14	65	20	73	69	65	14.0	855
701C2-16	16	74	22	82	78	74	15.0	1,180
701C2-18	18	84	24	92	88	84	16.0	1,450

CRITICAL GRADE OPTIONS

Available in three options: 700C (No internal packing), 701C (1" internal packing), 702C (2" internal packing).

CONNECTION OPTIONS

Standard Connections	125/150# ANSI Pattern flanged inlet and outlet. Side inlet, end outlet. (Style 2)
Flush Mount Option	Flush mount inlet good for applications where space is extremely limited. *
Other Options	Flanged connections can be replaced with ID cuff, OD tube, NPT, etc. *

ADDITIONAL OPTIONS

- Mounting brackets can be removed or top mounted.
- Leak testing – per request, fee applicable
- Stainless steel *

*Contact factory for details.

CRITICAL GRADE 702C

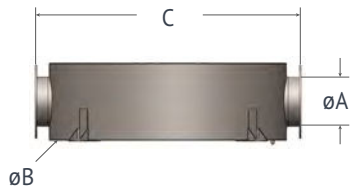

STYLE 1

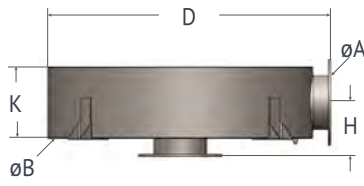

STYLE 2

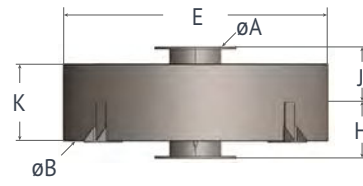

STYLE 3

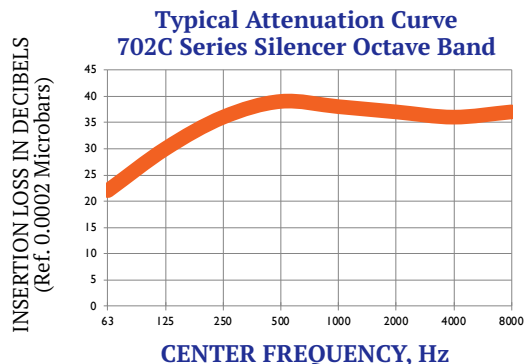

APPLICATION

- Engineered for applications where ambient noise level requirements are low.
 - Good for use in enclosures, trailers, marine or any other application where size restriction is a critical factor, and/or where controlling heat loss is extremely critical.
 - 2" thick packed shell design provides significant reduction of heat loss.
- Actual values depend on exhaust temp, ambient conditions and run time.*
- Typical Attenuation: 32 to 36 dBA

STANDARD BUILD

- Features compressed thermal/acoustical fiberglass packed shell.
- High heat black finish.
- Bottom mounting brackets.
- Fully-welded, heavy-duty carbon steel.

702C Dimensions (inches)

PART NUMBER	A OUTLET	B DIA	K HEIGHT	C OAL	D OAL	E OAL	H/J DIMS	WT
702C2-04	4	28	9	36	32	28	8.5	125
702C2-05	5	30	10	38	34	30	9.0	181
702C2-06	6	34	12	42	38	34	10.0	215
702C2-08	8	47	14	55	51	47	11.0	375
702C2-10	10	54	16	62	58	54	12.0	565
702C2-12	12	62	18	70	66	62	13.0	815
702C2-14	14	67	22	75	71	67	15.0	955
702C2-16	16	76	24	84	80	76	16.0	1,310
702C2-18	18	86	26	94	90	86	17.0	1,630

CRITICAL GRADE OPTIONS

Available in three options: 700C (No internal packing), 701C (1" internal packing), 702C (2" internal packing).

CONNECTION OPTIONS

Standard Connections	125/150# ANSI Pattern flanged inlet and outlet. Side inlet, end outlet. (Style 2)
Flush Mount Option	Flush mount inlet good for applications where space is extremely limited. *
Other Options	Flanged connections can be replaced with ID cuff, OD tube, NPT, etc. *

ADDITIONAL OPTIONS

- Mounting brackets can be removed or top mounted.
- Leak testing – per request, fee applicable
- Stainless steel *

*Contact factory for details.



HOSPITAL GRADE 701H

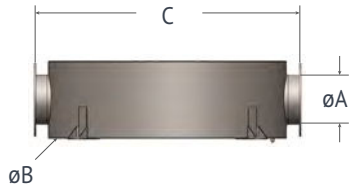

STYLE 1

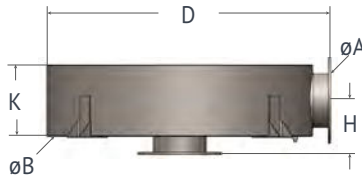

STYLE 2

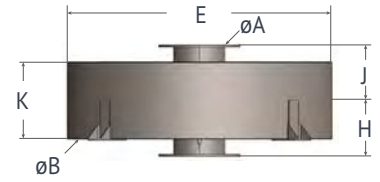

STYLE 3

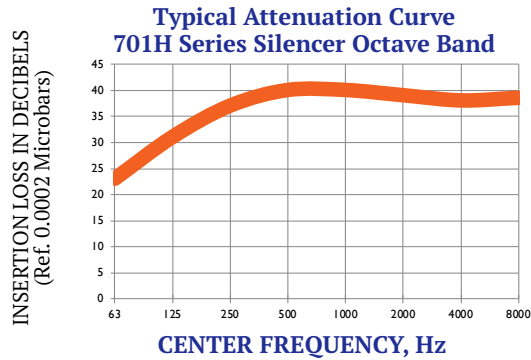

APPLICATION

- Engineered for applications where ambient noise level requirements are very low, and a high degree of attenuation is required.
- Good for use in enclosures, trailers, marine or any other application where size restriction is a critical factor.
- 1" thick packed shell design provides significant reduction of outer surface temp. *Actual values depend on exhaust temp, ambient conditions and run time.*
- Typical Attenuation: 33 to 38 dBA

STANDARD BUILD

- Features compressed thermal/acoustical fiberglass packed shell.
- High heat black finish.
- Bottom mounting brackets.
- Fully-welded, heavy-duty carbon steel.

701H Dimensions (inches)

PART NUMBER	A OUTLET	B DIA	K HEIGHT	C OAL	D OAL	E OAL	H/J DIMS	WT
701H2-04	4	30	8	38	34	30	8.0	146
701H2-05	5	32	9	40	36	32	8.5	179
701H2-06	6	36	10	44	40	36	9.0	235
701H2-08	8	50	12	58	54	50	10.0	492
701H2-10	10	58	14	64	60	58	11.0	575
701H2-12	12	70	16	78	74	70	12.0	908
701H2-14	14	72	22	80	76	72	15.0	1,039
701H2-16	16	74	26	82	78	74	17.0	1,138
701H2-18	18	84	28	92	88	84	18.0	1,597

HOSPITAL GRADE OPTIONS

Available in two options: 701H (1" internal packing), 702H (2" internal packing).

CONNECTION OPTIONS

Standard Connections	125/150# ANSI Pattern flanged inlet and outlet. Side inlet, end outlet. (Style 2)
Flush Mount Option	Flush mount inlet good for applications where space is extremely limited. *
Other Options	Flanged connections can be replaced with ID cuff, OD tube, NPT, etc. *

ADDITIONAL OPTIONS

- Mounting brackets can be removed or top mounted.
- Leak testing – per request, fee applicable
- Stainless steel *

*Contact factory for details.

HOSPITAL GRADE 702H

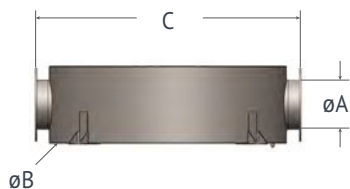

STYLE 1

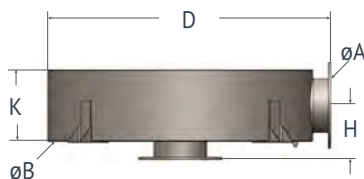

STYLE 2

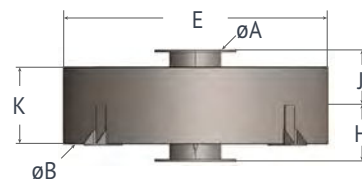

STYLE 3

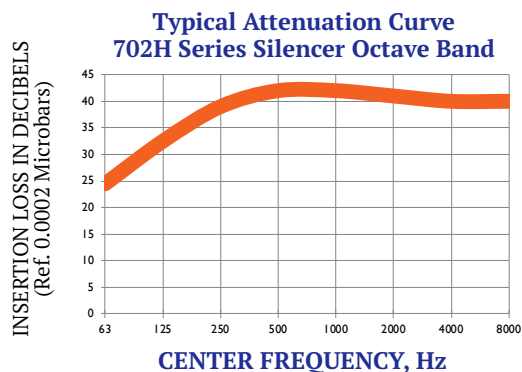

APPLICATION

- Engineered for applications where ambient noise level requirements are low, and a high degree of attenuation is required.
- Good for use in enclosures, trailers, marine or any other application where size restriction is a critical factor, and/or where controlling heat loss is extremely critical.
- 2" thick packed shell design provides significant reduction of outer surface temp. *Actual values depend on exhaust temp, ambient conditions and run time.*
- Typical Attenuation: 34 to 40 dBA

STANDARD BUILD

- Features compressed thermal/acoustical fiberglass packed shell.
- High heat black finish.
- Bottom mounting brackets.
- Fully-welded, heavy-duty carbon steel.

702H Dimensions (inches)

PART NUMBER	A OUTLET	B DIA	K HEIGHT	C OAL	D OAL	E OAL	H/J DIMS	WT
702H2-04	4	32	10	40	36	32	9.0	170
702H2-05	5	34	11	42	38	34	9.5	205
702H2-06	6	38	12	46	42	38	10.0	276
702H2-08	8	52	14	60	56	52	11.0	550
702H2-10	10	60	16	68	64	60	12.0	756
702H2-12	12	72	18	80	76	72	13.0	1,005
702H2-14	14	74	24	82	78	74	16.0	1,144
702H2-16	16	76	28	84	80	76	18.0	1,364
702H2-18	18	86	30	94	90	86	19.0	1,755

HOSPITAL GRADE OPTIONS

Available in two options: 701H (1" internal packing), 702H (2" internal packing).

CONNECTION OPTIONS

Standard Connections	125/150# ANSI Pattern flanged inlet and outlet. Side inlet, end outlet. (Style 2)
Flush Mount Option	Flush mount inlet good for applications where space is extremely limited. *
Other Options	Flanged connections can be replaced with ID cuff, OD tube, NPT, etc. *

ADDITIONAL OPTIONS

- Mounting brackets can be removed or top mounted.
- Leak testing – per request, fee applicable
- Stainless steel - contact factory for pricing

*Contact factory for details.



RESIDENTIAL GRADE 701SAR

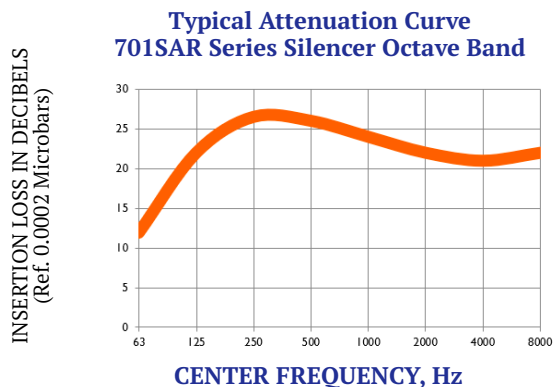

APPLICATION

- A spark arresting disk silencer ideal for applications in which overall height is critical and/or low radiated heat is necessary.
- For use on the exhaust of internal combustion engines where fire hazards exist.
- Designed to utilize centrifugal force to separate solids from the exhaust gas stream and deposited in an easily accessible clean-out.
- 1" thick packed shell design provides significant reduction of outer surface temp. *Actual values depend on exhaust temp, ambient conditions and run time.*
- Typical Attenuation: 19-25 dBA

STANDARD BUILD

- Features compressed thermal/acoustical fiberglass packed shell.
- High heat black finish.
- Bottom mounting brackets.
- Fully-welded, heavy-duty carbon steel.

701SAR Dimensions (inches)

PART NUMBER	A OUTLET	<p>Please contact us for specifications and pricing. Sales@inExhaust.com or 402-322-7022</p>	
701SAR-04	4		
701SAR-05	5		
701SAR-06	6		
701SAR-08	8		
701SAR-10	10		
701SAR-12	12		
701SAR-14	14		
701SAR-16	16		
701SAR-18	18		

CONNECTION OPTIONS

Standard Connections	125/150# ANSI Pattern flanged inlet and outlet. Side inlet, end outlet. (Style 2)
Flush Mount Option	Flush mount inlet good for applications where space is extremely limited. *
Other Options	Flanged connections can be replaced with ID cuff, OD tube, NPT, etc. *

ADDITIONAL OPTIONS

- Mounting brackets can be removed or top mounted.
- Leak testing – per request, fee applicable
- Stainless steel *

*Contact factory for details.

CRITICAL GRADE 701SAC

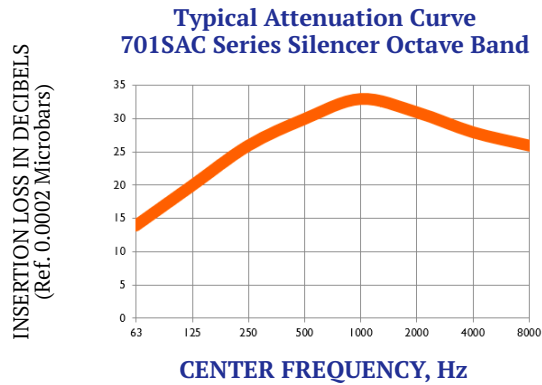

APPLICATION

- A spark arresting disk silencer ideal for applications in which overall height is critical and/or low radiated heat is necessary.
- For use on the exhaust of internal combustion engines where fire hazards exist.
- Designed to utilize centrifugal force to separate solids from the exhaust gas stream and deposited in an easily accessible clean-out.
- 1" thick packed shell design provides significant reduction of outer surface temp. *Actual values depend on exhaust temp, ambient conditions and run time.*
- Typical Attenuation: 27-32 dBA

STANDARD BUILD

- Features compressed thermal/acoustical fiberglass packed shell.
- High heat black finish.
- Bottom mounting brackets.
- Fully-welded, heavy-duty carbon steel.

701SAC Dimensions (inches)

PART NUMBER	A OUTLET	<p>Please contact us for specifications and pricing. Sales@inExhaust.com or 402-322-7022</p>
701SAC-04	4	
701SAC-05	5	
701SAC-06	6	
701SAC-08	8	
701SAC-10	10	
701SAC-12	12	
701SAC-14	14	
701SAC-16	16	
701SAC-18	18	

CONNECTION OPTIONS

Standard Connections	125/150# ANSI Pattern flanged inlet and outlet. Side inlet, end outlet. (Style 2)
Flush Mount Option	Flush mount inlet good for applications where space is extremely limited. *
Other Options	Flanged connections can be replaced with ID cuff, OD tube, NPT, etc. *

ADDITIONAL OPTIONS

- Mounting brackets can be removed or top mounted.
- Leak testing – per request, fee applicable
- Stainless steel *

*Contact factory for details.



RESIDENTIAL GRADE 800R

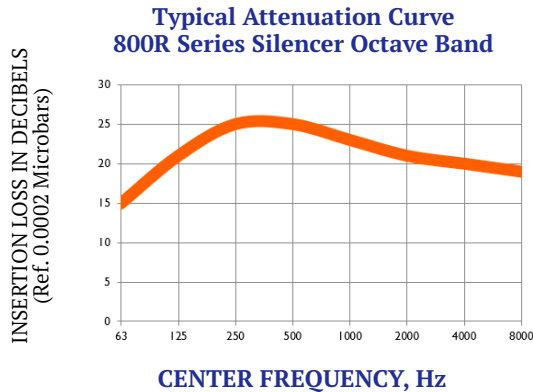

APPLICATION

- Advanced design provides high attenuation and low-pressure drop in a space-saving compact size.
- Excellent for use where weight and size are critical factors.
- Ideal for use where ambient noise level requirements are moderate to low.
- Typical Attenuation: 18-25 dBA

STANDARD BUILD

- Features compressed thermal/acoustical fiberglass packed shell.
- High heat black finish.
- Fully-welded, heavy-duty carbon steel.

800R Dimensions (inches)

PART NUMBER	A OUTLET	<p>Please contact us for specifications and pricing. Sales@inExhaust.com or 402-322-7022</p>	
800R-04	4		
800R-05	5		
800R-06	6		
800R-08	8		
800R-10	10		
800R-12	12		
800R-14	14		
800R-16	16		
800R-18	18		

CONNECTION OPTIONS

Standard Connections	ID Cuff Inlet, OD Tube Outlet
Flush Mount Option	Flush mount inlet good for applications where space is extremely limited.*
Other Options	Standard connections can be replaced with Flanges, NPT, etc.*

ADDITIONAL OPTIONS

- Leak testing – per request, fee applicable
- Stainless steel *

*Contact factory for details.

CRITICAL GRADE 800C

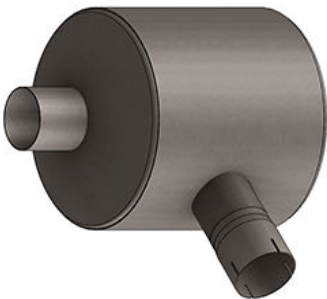
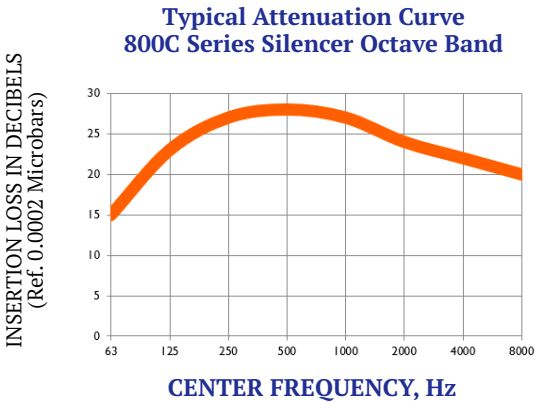

APPLICATION

- Advanced design provides high attenuation and low-pressure drop in a space-saving compact size.
- Excellent for use where weight and size are critical factors.
- Ideal for use where ambient noise level requirements are moderate to low.
- Typical Attenuation: 23-28 dBA

STANDARD BUILD

- Features compressed thermal/acoustical fiberglass packed shell.
- High heat black finish.
- Fully-welded, heavy-duty carbon steel.

800C Dimensions (inches)

PART NUMBER	A OUTLET
800C-04	4
800C-05	5
800C-06	6
800C-08	8
800C-10	10
800C-12	12
800C-14	14
800C-16	16
800C-18	18

Please contact us for specifications and pricing.
Sales@inExhaust.com or 402-322-7022

CONNECTION OPTIONS	
Standard Connections	ID Cuff Inlet, OD Tube Outlet
Flush Mount Option	Flush mount inlet good for applications where space is extremely limited.*
Other Options	Standard connections can be replaced with Flanges, NPT, etc. *

ADDITIONAL OPTIONS

- Leak testing – per request, fee applicable
- Stainless steel *

*Contact factory for details.

HOSPITAL GRADE 800H

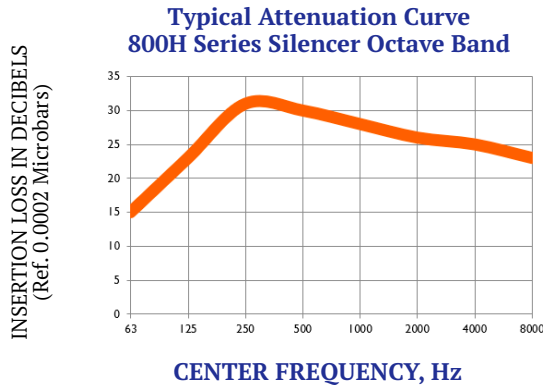

APPLICATION

- Advanced design provides high attenuation and low-pressure drop in a space-saving compact size.
- Excellent for use where weight and size are critical factors.
- Ideal for use where ambient noise level requirements are moderate to low.
- Typical Attenuation: 25-30 dBA

STANDARD BUILD

- Features compressed thermal/acoustical fiberglass packed shell.
- High heat black finish.
- Fully-welded, heavy-duty carbon steel.

800H Dimensions (inches)

PART NUMBER	A OUTLET	<p>Please contact us for specifications and pricing. Sales@inExhaust.com or 402-322-7022</p>
800H-04	4	
800H-05	5	
800H-06	6	
800H-08	8	
800H-10	10	
800H-12	12	
800H-14	14	
800H-16	16	
800H-18	18	

CONNECTION OPTIONS

Standard Connections	ID Cuff Inlet, OD Tube Outlet
Flush Mount Option	Flush mount inlet good for applications where space is extremely limited.*
Other Options	Standard connections can be replaced with Flanges, NPT, etc.*

ADDITIONAL OPTIONS

- Leak testing – per request, fee applicable
- Stainless steel *

*Contact factory for details.

INDUSTRIAL GRADE 900I

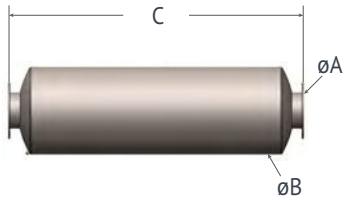

STYLE 1

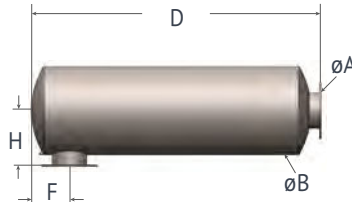

STYLE 2

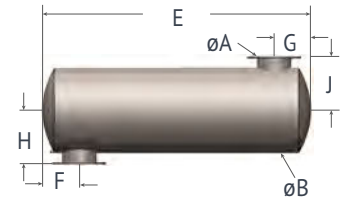

STYLE 3

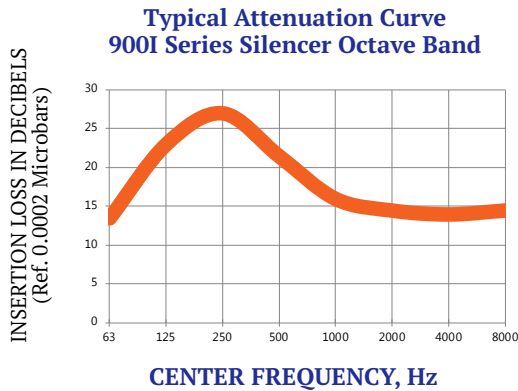

APPLICATION

- Engineered for applications where ambient noise level requirements are high.
- May be installed in any position.
- Typical Attenuation: 14 to 20 dBA

STANDARD BUILD

- Internally unpacked silencer.
- High heat black finish.
- Fully-welded, heavy-duty carbon steel.

900I Dimensions (inches)

PART NUMBER	A OUTLET	B DIA	C OAL	D OAL	E OAL	F MIN	F MAX	G MIN	G MAX	H/J DIMS	WT
900I2-04	4	10	36	33	30	5	13	5	9	8	40
900I2-05	5	12	42	39	36	6	15	6	12	9	50
900I2-06	6	14	42	39	37	7	15	7	11	10	60
900I2-08	8	18	47	44	42	9	16	9	12	12	115
900I2-10	10	24	63	59	56	11	22	11	17	16	185
900I2-12	12	26	63	59	56	12	20	12	17	17	240
900I2-14	14	30	74	71	68	13	27	13	20	19	350

CONNECTION OPTIONS

Standard Connections

125/150# ANSI Pattern flanged inlet and outlet. Side inlet, end outlet. (Style 2)

Other Options

Flanged connections can be replaced with ID cuff, OD tube, NPT, etc. *

ADDITIONAL OPTIONS

- Leak testing – per request, fee applicable
- Stainless steel *

*Contact factory for details.



RESIDENTIAL GRADE 900R

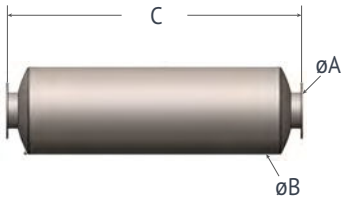

STYLE 1

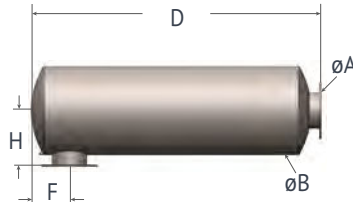

STYLE 2

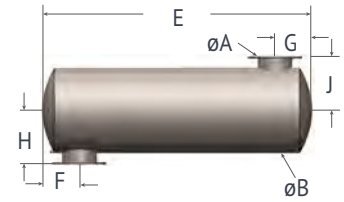

STYLE 3

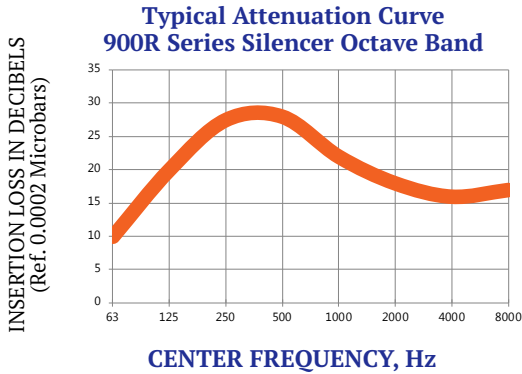

APPLICATION

- Engineered for applications where ambient noise level requirements are moderate.
- Suited for heavy-duty stationary and mobile applications in both Commercial & Residential.
- May be installed in any position.
- Typical Attenuation: 19 to 25 dBA

STANDARD BUILD

- Internally unpacked silencer.
- High heat black finish.
- Fully-welded, heavy-duty carbon steel.

900R Dimensions (inches)

PART NUMBER	A OUTLET	B DIA	C OAL	D OAL	E OAL	F MIN	F MAX	G MIN	G MAX	H/J DIMS	WT
900R2-04	4	10	45	42	39	5	20	5	14	8	45
900R2-05	5	12	54	51	48	6	25	6	14	9	62
900R2-06	6	14	54	51	49	7	24	7	17	10	80
900R2-08	8	18	61	57	54	9	26	9	14	13	130
900R2-10	10	24	74	71	67	12	32	12	18	16	230
900R2-12	12	26	75	72	68	13	33	13	16	17	270
900R2-14	14	30	99	96	92	14	47	14	25	19	430
900R2-16	16	36	113	110	107	16	51	16	31	22	590
900R2-18	18	36	125	122	119	17	60	17	33	22	700
900R2-20	20	42	140	135	131	19	66	19	36	26	1,050
900R2-22	22	48	143	139	135	21	66	21	37	29	1,280
900R2-24	24	54	144	140	137	23	67	23	34	32	1,460

CONNECTION OPTIONS

Standard Connections

125/150# ANSI Pattern flanged inlet and outlet. Side inlet, end outlet. (Style 2)

Other Options

Flanged connections can be replaced with ID cuff, OD tube, NPT, etc. *

ADDITIONAL OPTIONS

- Leak testing – per request, fee applicable
- Stainless steel *

*Contact factory for details.

CRITICAL GRADE 900C

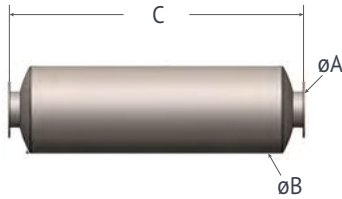

STYLE 1

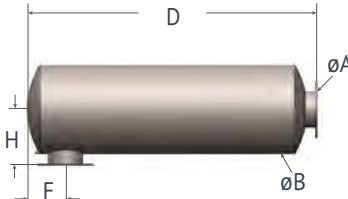

STYLE 2

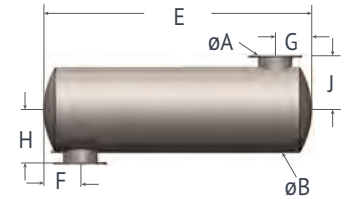

STYLE 3

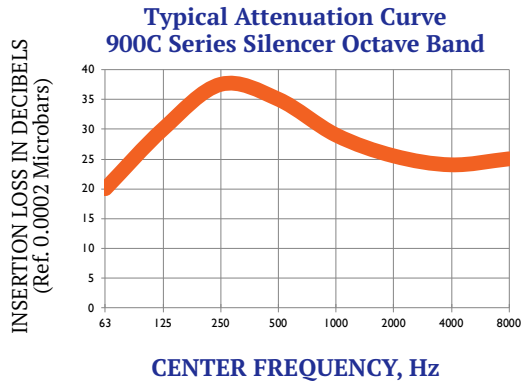

APPLICATION

- Engineered for areas where ambient noise level requirements are very low and a high degree of silencing is required.
- Suited for heavy-duty stationary and mobile applications in both Critical & Residential.
- May be installed in any position.
- Typical Attenuation: 25 to 33 dBA

STANDARD BUILD

- Internally unpacked silencer.
- High heat black finish.
- Fully-welded, heavy-duty carbon steel.

900C Dimensions (inches)

PART NUMBER	A OUTLET	B DIA	C OAL	D OAL	E OAL	F MIN	F MAX	G MIN	G MAX	H/J DIMS	WT
900C2-02	2	8	31	28	25	4	11	4	9	7	35
900C2-025	2.5	8	41	38	35	4	16	4	12	7	48
900C2-03	3	10	41	38	35	5	16	5	13	8	60
900C2-035	3.5	10	52	49	46	5	22	5	17	8	80
900C2-04	4	14	53	50	47	6	22	6	17	10	105
900C2-05	5	16	61	57	54	7	25	7	19	12	140
900C2-06	6	18	73	69	66	8	31	8	23	13	205
900C2-08	8	24	75	71	67	10	29	10	24	16	310
900C2-10	10	26	100	96	92	11	46	11	30	17	450
900C2-12	12	30	100	96	92	12	43	12	32	19	610
900C2-14	14	36	138	134	131	15	58	15	47	22	1,030
900C2-16	16	42	139	135	132	16	56	16	51	25	1,350
900C2-18	18	48	143	139	134	19	56	19	49	29	1,630
900C2-20	20	48	166	162	158	20	67	20	55	29	1,910
900C2-22	22	54	168	164	161	22	67	22	60	32	2,200
900C2-24	24	60	170	167	163	24	68	24	59	35	2,875

CONNECTION OPTIONS

Standard Connections

125/150# ANSI Pattern flanged inlet and outlet. Side inlet, end outlet. (Style 2)

Other Options

Flanged connections can be replaced with ID cuff, OD tube, NPT, etc. *

Contact factory for details.

ADDITIONAL OPTIONS

- Leak testing – per request, fee applicable
- Stainless steel *



HOSPITAL GRADE 900H

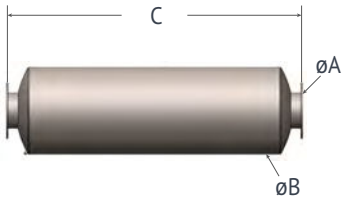

STYLE 1

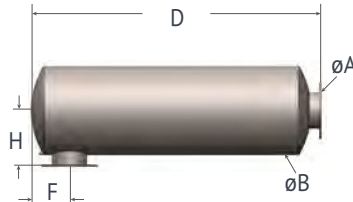

STYLE 2

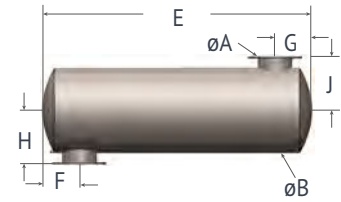

STYLE 3

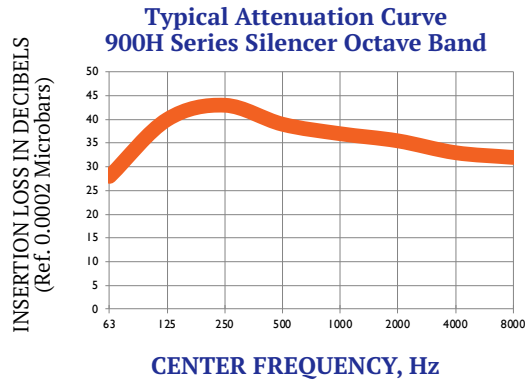

APPLICATION

- Engineered to provide a premium level of performance where ambient noise level requirements are very low and optimal attenuation is mandatory.
- May be installed in any position.
- Typical Attenuation: 32 to 40 dBA

STANDARD BUILD

- Features compressed thermal/acoustical fiberglass packed shell.
- Fully-welded heavy-duty carbon steel double-shell construction.
- High heat black finish.

900H Dimensions (inches)

PART NUMBER	A OUTLET	B DIA	C OAL	D OAL	E OAL	F MIN	F MAX	G MIN	G MAX	H/J DIMS	WT
900H2-04	4	16	60	56	52	6	24	6	19	12	155
900H2-05	5	18	61	58	54	8	24	8	19	13	185
900H2-06	6	20	74	70	67	9	30	9	24	14	260
900H2-08	8	26	97	94	90	10	46	10	28	17	450
900H2-10	10	30	111	108	104	12	45	12	42	19	690
900H2-12	12	36	138	134	130	14	57	14	52	22	1025
900H2-14	14	42	152	148	144	16	68	16	51	26	1,500
900H2-16	16	42	164	160	156	16	75	16	55	26	1,625
900H2-18	18	48	179	174	170	18	79	18	61	29	2,050
900H2-20	20	54	180	177	173	21	79	21	61	32	2,400
900H2-22	22	60	206	202	198	23	95	23	67	35	3,475
900H2-24	24	62	205	202	199	24	91	24	69	36	3,750

CONNECTION OPTIONS

Standard Connections	125/150# ANSI Pattern flanged inlet and outlet. Side inlet, end outlet. (Style 2)
Other Options	Flanged connections can be replaced with ID cuff, OD tube, NPT, etc. *

ADDITIONAL OPTIONS

- Leak testing – per request, fee applicable
- Stainless steel *

*Contact factory for details.

EXTREME GRADE 900E



STYLE 1



STYLE 2

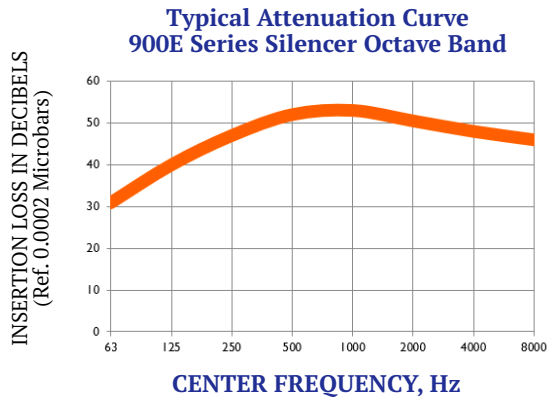

APPLICATION

- Engineered for areas where extreme exhaust noise attenuation is required.
- May be installed in any position.
- Typical Attenuation: 45 to 52 dBA

STANDARD BUILD

- Features compressed thermal/acoustical fiberglass packed shell.
- Heavy-duty, double shell.
- High heat black finish.
- Fully-welded, heavy-duty carbon steel.

900E Dimensions (inches)

PART NUMBER	A OUTLET	<p>Please contact us for specifications and pricing. Sales@inExhaust.com or 402-322-7022</p>
900E2-04	4	
900E2-05	5	
900E2-06	6	
900E2-08	8	
900E2-10	10	
900E2-12	12	
900E2-14	14	
900E2-16	16	
900E2-18	18	
900E2-20	20	
900E2-22	22	
900E2-24	24	

CONNECTION OPTIONS

Standard Connections	125/150# ANSI Pattern flanged inlet and outlet. Side inlet, end outlet. (Style 2)
Other Options	Flanged connections can be replaced with ID cuff, OD tube, NPT, etc. *

ADDITIONAL OPTIONS

- Leak testing – per request, fee applicable
- Stainless steel *

*Contact factory for details.



RESIDENTIAL GRADE 90SAR

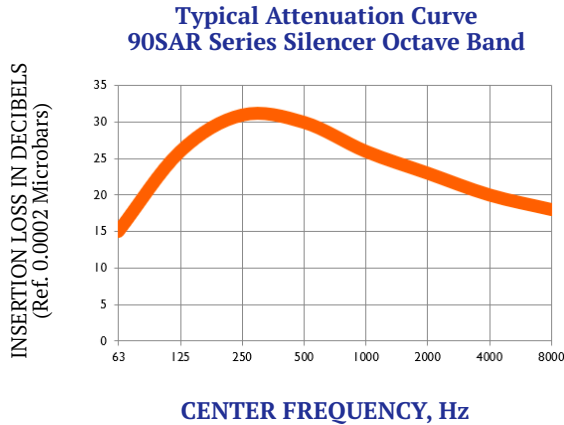

APPLICATION

- A spark arresting cylindrical silencer for use on the exhaust of internal combustion engines that are located where fire hazards exist.
- Designed to utilize centrifugal force to separate solids from the exhaust gas stream and deposit in an easily accessible clean-out.
- Typical Attenuation: 18-25 dBA

STANDARD BUILD

- Internally unpacked silencer.
- High heat black finish.
- Fully-welded, heavy-duty carbon steel.

90SAR Dimensions (inches)

PART NUMBER	A OUTLET	<p>Please contact us for specifications and pricing. Sales@inExhaust.com or 402-322-7022</p>
90SAR-04	4	
90SAR-05	5	
90SAR-06	6	
90SAR-08	8	
90SAR-10	10	
90SAR-12	12	
90SAR-14	14	
90SAR-16	16	
90SAR-18	18	
90SAR-20	20	
90SAR-22	22	
90SAR-24	24	

CONNECTION OPTIONS

Standard Connections	125/150# ANSI Pattern flanged inlet and outlet. Side inlet, end outlet. (Style 2)
Other Options	Flanged connections can be replaced with ID cuff, OD tube, NPT, etc. *

ADDITIONAL OPTIONS

- Leak testing – per request, fee applicable
- Stainless steel *

*Contact factory for details.



CRITICAL GRADE 90SAC

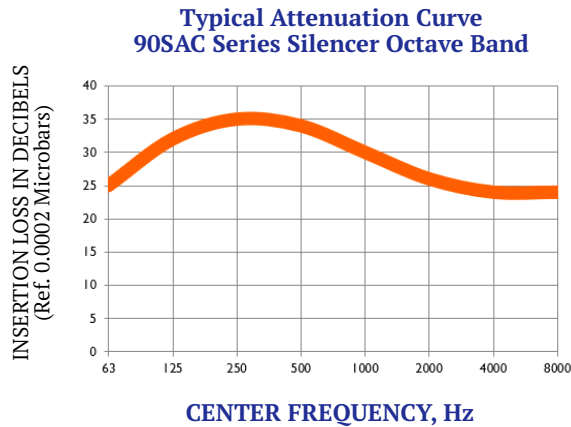

APPLICATION

- A spark arresting cylindrical silencer for use on the exhaust of internal combustion engines that are located where fire hazards exist.
- Designed to utilize centrifugal force to separate solids from the exhaust gas stream and deposit in an easily accessible clean-out.
- Typical Attenuation: 25-31 dBA

STANDARD BUILD

- Internally unpacked silencer.
- High heat black finish.
- Fully-welded, heavy-duty carbon steel.

90SAC Dimensions (inches)

PART NUMBER	A OUTLET	<p>Please contact us for specifications and pricing. Sales@inExhaust.com or 402-322-7022</p>
90SAC-04	4	
90SAC-05	5	
90SAC-06	6	
90SAC-08	8	
90SAC-10	10	
90SAC-12	12	
90SAC-14	14	
90SAC-16	16	
90SAC-18	18	
90SAC-20	20	
90SAC-22	22	
90SAC-24	24	

CONNECTION OPTIONS

Standard Connections

125/150# ANSI Pattern flanged inlet and outlet. Side inlet, end outlet. (Style 2)

Other Options

Flanged connections can be replaced with ID cuff, OD tube, NPT, etc. *

ADDITIONAL OPTIONS

- Leak testing – per request, fee applicable
- Stainless steel *

*Contact factory for details.



HOSPITAL GRADE 90SAH

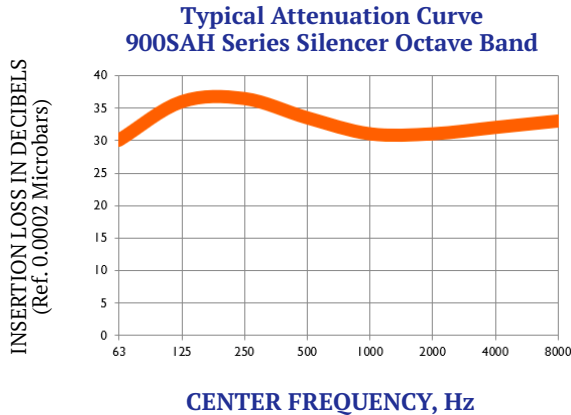

APPLICATION

- A spark arresting cylindrical silencer for use on the exhaust of internal combustion engines that are located where fire hazards exist.
- Designed to utilize centrifugal force to separate solids from the exhaust gas stream and deposit in an easily accessible clean-out.
- Typical Attenuation: 30-38 dBA

STANDARD BUILD

- Features compressed thermal/acoustical fiberglass packed shell.
- High heat black finish.
- Fully-welded, heavy-duty carbon steel.

90SAH Dimensions (inches)

PART NUMBER	A OUTLET
90SAH-04	4
90SAH-05	5
90SAH-06	6
90SAH-08	8
90SAH-10	10
90SAH-12	12
90SAH-14	14
90SAH-16	16
90SAH-18	18
90SAH-20	20
90SAH-22	22
90SAH-24	24

Please contact us for specifications and pricing.
Sales@inExhaust.com or 402-322-7022

CONNECTION OPTIONS

Standard Connections

125/150# ANSI Pattern flanged inlet and outlet. Side inlet, end outlet. (Style 2)

Other Options

Flanged connections can be replaced with ID cuff, OD tube, NPT, etc. *

ADDITIONAL OPTIONS

- Leak testing – per request, fee applicable
- Stainless steel *

*Contact factory for details.



INDUSTRIAL GRADE 90SAI

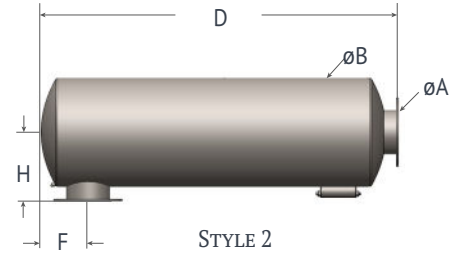
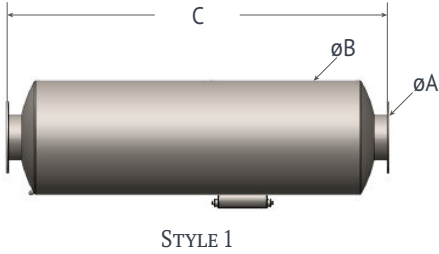

**Typical Attenuation Curve
90SAI Series Silencer Octave Band**

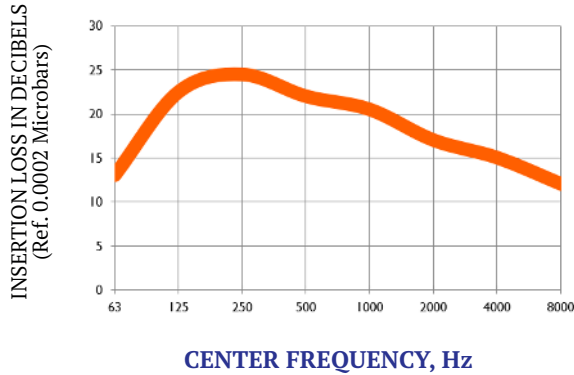

APPLICATION

- A spark arresting cylindrical silencer for use on the exhaust of internal combustion engines that are located where fire hazards exist.
- Designed to utilize centrifugal force to separate solids from the exhaust gas stream and deposit in an easily accessible clean-out.
- Typical Attenuation: 12-23 dBA

STANDARD BUILD

- Internally unpacked silencer.
- High heat black finish.
- Fully-welded, heavy-duty carbon steel.

90SAI Dimensions (inches)

PART NUMBER	A OUTLET	B DIA	C OAL	D OAL	F MIN	F MAX	H	WT
90SAI-04	4	10	36	33	5	9	8	45
90SAI-05	5	10	42	39	6	12	9	55
90SAI-06	6	14	42	39	7	12	10	65
90SAI-08	8	18	47	44	9	11	12	120
90SAI-10	10	24	63	59	11	15	16	200
90SAI-12	12	26	63	59	12	13	17	300
90SAI-14	14	30	74	71	13	19	19	375
90SAI-16	16	42	81	77	16	16	25	726
90SAI-18	18	48	100	96	18	22	28	985
90SAI-20	20	48	118	114	20	29	28	1,107
90SAI-22	22	54	120	116	21	29	31	1,299
90SAI-24	24	60	132	128	24	33	34	1,589

CONNECTION OPTIONS

Standard Connections	125/150# ANSI Pattern flanged inlet and outlet. Side inlet, end outlet. (Style 2)
Other Options	Flanged connections can be replaced with ID cuff, OD tube, NPT, etc. *

ADDITIONAL OPTIONS

- Leak testing – per request, fee applicable
- Stainless steel *

*Contact factory for details.



Vertical Type
85-V



Foot Type
85-F



Leg Type
85-L



Trunion
Type 85-T



Horizontal Type
85-H



Please contact us for specifications and pricing.
Sales@inExhaust.com or 402-322-7022

COMMON APPLICATIONS

To protect atmospheric vessels such as exhaust silencers from damage due to sudden pressure rises. (Backfires, etc.)

OPENING PRESSURE

Approximately 5 PSIG.

NOTE: Only kits installed at the factory are covered under warranty.

EXPLOSION RELIEF COVER KITS

PART NUMBER	NS	RECOMMENDED FOR SILENCER NOMINAL SIZES	A OD	B BHC	C OD	D # OF SPRINGS	E OAL WITHOUT SPRINGS
68-120-KIT	12	4" through 8"	12	13.75	15.75	6	6
68-150-KIT	15	10" through 16"	15	17	18.75	12	6
68-19.5-KIT	19.5	18" through 40"	19.375	21.25	23	16	6

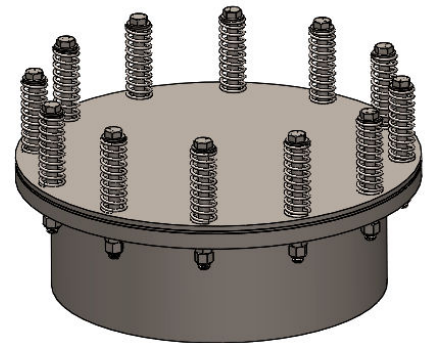
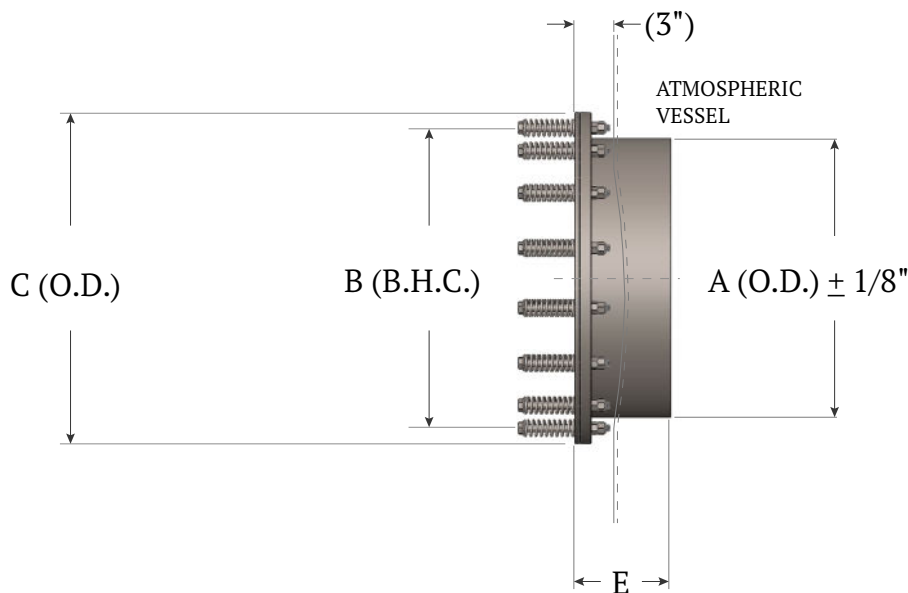

Kit Contents

- Cover: Carbon steel plate.
- Flange: Carbon steel plate with equally spaced holes.
- Springs: Carbon steel compression springs, zinc plated.
NOTE: Springs are compressed to 3.5" length. Heat will affect spring rate.
- Fasteners: Carbon steel, heavy hex, zinc plated, 1/2" x 6" long.
Includes hex nut, hex jam nut and washer.
- Gasket: Full face graphite.

Read through the entire manual before proceeding with installation.

Any procedures presented in this guide are suggestions only, and it is the responsibility of the owner/operator to ensure that the installation is done only by trained, qualified individuals, and performed according to all applicable codes including, but not limited to, local codes for your municipality, city, county and state; this includes all electrical and mechanical work. All workers must be trained in the proper safety procedures and appropriate PPE and attire must be worn at all times.

It is recommended that the user ensure the entire exhaust system has been received undamaged, is properly designed, and laid out before installing parts. Ensure that the necessary equipment to install the unit are available before beginning. (Support brackets, gaskets, nuts and bolts, outlet elbows, expansion joints, etc...).

The unit is designed to support its own weight and not designed to serve as a support for any piping or additional loads on the inlet or outlet. Ensure the unit is mounted evenly and securely and must be mounted on structural supports. For the final installation, do not support the unit by the flanges.

PRE-INSTALLATION

- Prior to unpacking, check all components for shipping damage.
- Verify the correct parts are received by comparing the nameplate with the packing list.
- Locate nameplate and note direction (if applicable).
- Keep shipping materials intact to protect the unit until installation is complete.
- Verify that the silencer and recommended gaskets are of proper size for the mating surface openings and ensure that all mating surfaces are clean and free of foreign material before installation.
- Observe all OSHA mandated regulations for the safe rigging of exhaust equipment.
- When cleaning the surfaces, do not use abrasive materials such as steel wool or wire brushes. Use only isopropyl alcohol and clean with soft rags. (Do not use chloride or halide-based cleaners.)
- Exhaust system components inside the enclosure may need to be covered with suitable insulation to protect personnel and reduce room temperature. Use only chloride and halide free insulation. (Removable Thermal Insulation Covers, aka Wrap, available from inExhaust™)
- Be sure to orient the unit in the proper manner for the indicated flow direction.
- If supplied, use all lifting lugs when hoisting the silencer into place, use all mounting feet when securing the silencer into its operating position. Ensure the unit is mounted evenly across the supports.
- To minimize turbulence and back-pressure, it is recommended that at least 5 tube diameters of straight pipe upstream of the silencer and 2.5 diameters downstream of the silencer be maintained.

INSTALLATION

- Align the unit with the engine and/or piping connections. Pre-loading flange connections due to misalignment will result in premature failure and will void the warranty.

Flanged Connections:

1. Flange faces must be parallel with each other and all mating surfaces must also be parallel.
2. Place the flange of the connector (floating flange, if applicable) over the exhaust outlet of the engine, with the gasket between the two facing surfaces and bolt holes properly mated, so that the axial lines of the connector and mating orifice are concentrically aligned.
3. Secure the flange over the mating face of the outlet using the appropriate grade bolts and nuts or an appropriate Nut-Bolt-Gasket (NBG) kit, to aid in maintaining joint tightness over time. Higher grade fasteners may loosen as the system settles, causing failure. Do not use spring lock washers, as operating

CONTINUED

temperatures and pressures will cause them to degrade or disintegrate. Apply high temperature anti-seize to bolts – Loctite® 34517 or equivalent is suggested (not included or supplied by inExhaust).

4. Secure the opposite flange of the connector to the mating face of the receiving system, with the gasket between the two facing surfaces and bolt holes properly mated. Use the same grade of fasteners as previously described, ensuring that the axial lines of the engine outlet, connector, and mating orifice remain concentrically aligned.

Caution:

- a) The installation must be pre-aligned so that bolts for all mating surfaces can drop into place with no force, offsetting, bending, twisting or other form of distortion.
- b) Pre-loading flange connections due to misalignment will result in premature failure and will void the warranty.

Cuffed Connections:

1. Ensure the clamp is loosely attached to either the cuff or the exhaust piping prior to fitting the exhaust piping to the cuff.
 2. Insert the exhaust piping securely into the cuffed portion of the connection, ensuring that the exhaust piping is uniformly bottomed out.
 3. Position the clamp towards the edge of the cuff, allowing a minimum of 0.5” from the edge of the clamp to the edge of the pipe.
 4. Torque the clamp bolts until tight. Re-check tightness prior to and after initial engine start and system commissioning.
- Install a suitable expansion joint (bellows or wye) between the silencer and the engine to reduce thermal growth damage to the unit and reduce some vibration transfer that could cause damage.
 - Make sure all ports, openings, and connections are clear from obstruction.
 - Ensure runs of exhaust piping are sloped away from the engine to prevent condensation and outside moisture from entering the engine. Drain traps should be installed at the lowest point in the line.

POST-INSTALLATION

- Review and ensure that all components of your exhaust system are properly installed and ready for operation.
- If there is any indication of leaks or damage, cease operation immediately and conduct a broader inspection to determine the cause and resolve.
- After the initial engine run and cool down, re-check all bolts for tightness and torque as required.
- Exhaust back-pressure must not exceed the allowable back-pressure specified by the engine manufacturer. Excessive exhaust back-pressure reduces engine power and engine life and may lead to high exhaust temperatures and smoke. Engine exhaust back-pressure should be estimated before the layout of the exhaust system is finalized and is recommended to be measured at the exhaust outlet under full-load operation, as needed.
- Verify that the type and amount of movement generated by the system are identical with movements the expansion joint is designed for.

MAINTENANCE

It is recommended that maintenance is performed monthly, or every 10 hours of operation, (whichever comes first).



CONTINUED

Maintenance for a typical exhaust system installation will consist of physical and visual examination of the exhaust system for any sign of gas leakage, cracks, significant areas of damage or corrosion. Re-tighten any loose bolts if necessary.

Note: If there is any indication of leaks or damage, cease operation immediately and conduct a broader inspection to determine the cause and resolve.

Thank you for choosing inExhaust as your exhaust system components solution!
For any questions, please contact us at sales@inExhaust.com.

inExhaust™ reserves the right to change the contents without notice. We do make every effort to have the most recent documents on our website. For latest revision please contact inExhaust™.

This guide is also available on our website: www.inExhaust.com



Slim Series



Disk Series



Cylindrical Series

- Please review the quotation/order when received to ensure accuracy on agreed price and lead time.
- Multiple parts and/or large quantity parts may extend lead times.
- Custom parts that are quoted and then ordered are non-refundable, non-restockable, and non-returnable.
- Freight is Ex Works (EXW) Factory.
- Minimum order \$50.

Delivery from inExhaust™, hereafter referred to as Manufacturer, is defined as the date/time the equipment leaves the Manufacturer's shipping dock.

Manufacturer provides two options for shipping terms. **By default, the Manufacturer shall choose Option 1 unless directed by the Purchaser or otherwise specified.**

OPTION 1

Shipment is Ex Works (EXW) Factory, Freight Prepaid & Add

- a) The Manufacturer pays and invoices Purchaser for freight charges
- b) The Purchaser assumes the title and control of the equipment at the moment the carrier signs the bill of lading
- c) The Manufacturer reserves the right to select the freight carrier
- d) The Purchaser is responsible for filing and settling claims for loss or damage of equipment

OPTION 2

Shipment is Ex Works (EXW) Origin Freight Collect.

- a) The Purchaser pays and bears the freight charges
 - b) The Purchaser assumes title and control of the equipment at the moment the carrier signs the bill of lading
 - c) The Purchaser is responsible for filing and settling claims for loss or damage of equipment
- All drawings and documents furnished to Purchaser by the Manufacturer is the work product of the Manufacturer who shall be deemed the author and shall retain all common law, statutory law and other rights of ownership, including copyrights. Purchaser may make and retain copies for informational purposes only.
 - The Manufacturer will endeavor to make shipment of orders as scheduled whenever possible. However, all shipment dates are approximate only, and the Manufacturer reserves the right to adjust shipment schedules at its sole discretion.

UNDER NO CIRCUMSTANCES WILL THE MANUFACTURER BE RESPONSIBLE OR INCUR ANY LIABILITY FOR COSTS OR DAMAGES OF ANY NATURE (WHETHER GENERAL, CONSEQUENTIAL, AS A PENALTY OR LIQUIDATED DAMAGES, OR OTHERWISE) ARISING OUT OF OR OWING TO ANY DELAYS IN DELIVERY.

Origin Freight Collect Delay of Shipment

When the equipment is ready for shipment and shipment is delayed or postponed through any causes, or at Purchaser's request, the Purchaser shall:

- Pay the Manufacturer's invoice for the equipment as per payment terms,
- Arrange for storage of the equipment covered by this agreement other than at the Manufacturer's facility, unless by separate written agreement the Manufacturer shall agree to store the equipment and the charges for such storage.



CONTINUED

- The Manufacturer warrants to the Purchaser that it will repair or replace at Manufacturer's option, any equipment, or parts of equipment, which, in the Manufacturer's judgment is defective in material or workmanship for a period of one (1) year after the date of shipment from the Manufacturer's facility.
- Equipment, accessories and other parts and components not manufactured by the Manufacturer are warranted only to the extent of and by the original manufacturer's warranty to the Manufacturer, and in no event shall such other manufacturer's warranty create any more extensive obligations of the Manufacturer to the Purchaser than the Manufacturer's warranty covering equipment manufactured by the Manufacturer.

NOTE: Upon receipt of shipment, customer is responsible for inspection of items. Most carriers require immediate notification of damage. This means inspection must be made at time of delivery and any damage must be noted on the carrier's paperwork. A signature without mention of damage is considered "clear" by the carrier and will not be covered under insurance.

Any missing or damaged goods must be reported in writing to the vendor within 30 days from date of receipt. Lack of notification within 30 days will be considered as complete and satisfactory delivery of goods.

Thank you for choosing inExhaust as your exhaust system components solution!
For any questions, please contact us at sales@inExhaust.com.

inExhaust™ reserves the right to change the contents without notice. We do make every effort to have the most recent documents on our website. For latest revision please contact inExhaust™.

This document is also available on our website: www.inExhaust.com

inExhaust™, hereafter referred to as Manufacturer, warrants to the Purchaser that it will repair or replace at the Manufacturer's option, any equipment, or parts of equipment, which, in the Manufacturer's judgment is defective in material or workmanship for a period of one (1) year after the date of shipment from the Manufacturer's facility.

Defects or failure due to improper or careless storage, handling, installation, non-manufacturing welding/hot-work, application, testing/cycling without correct amount of time to allow system to warm up stabilize, evaporate combustion moisture and improper moisture draining either from condensation, emission or environmental introduction of moisture inside exhaust components exclude Manufacturer from upholding warranty.

Other exclusions include undisclosed/unspecified/alternate application, or corrosion accelerated due to smog, salinity, or other corrosive environments or combustion emissions (i.e. alternative fuel sources), poor or inadequate maintenance, or acts of God.

Damage from backfires, or from other malfunctioning engine conditions is not covered. Damage from excessive exhaust temperature beyond information provided at time of quote is not covered. For exhaust temperatures near 1000F or higher purchaser must disclose intention to externally insulate exhaust products especially with carbon steel as material of construction. Damage from other chemical or flammable substances encountering exhaust products is not covered.

Equipment, accessories and other parts and components sold by but not manufactured by the Manufacturer are warranted only to the extent of and by the original manufacturer's warranty to the Manufacturer, and in no event shall such other manufacturer's warranty create any more extensive obligations of the Manufacturer to the Purchaser other than the Manufacturer's warranty covering equipment manufactured by the Manufacturer. Manufacturer does not warrant any labor for removal, re-installation or maintenance of components.

SHIPPING

Manufacturer will endeavor to make shipment of orders as scheduled. However, all shipment dates are approximate only, and the Manufacturer reserves the right to adjust shipment schedules at its sole discretion.

No liability is accepted for return transportation charges, following the repair or replacement, or for re-installation cost. No other expressed or implied warranties exist in the absence of special written agreement between the consumer and Manufacturer.

Under no circumstances will the Manufacturer be responsible or incur any liability for costs or damages of any nature (whether general, consequential, as a penalty or liquidated damages, or otherwise) arising out of or owing to any delays in delivery.

THE MANUFACTURER SHALL NOT BE LIABLE FOR ANY SPECIAL, INDIRECT, INCIDENTAL, DELAY OR CONSEQUENTIAL DAMAGES, OR FOR LOSS, DAMAGE OR EXPENSE, DIRECTLY OR INDIRECTLY ARISING FROM THE USE OF THE EQUIPMENT, SPARE OR REPLACEMENT PARTS, OR FROM ANY OTHER CAUSE WHETHER BASED ON WARRANTY (EXPRESSED OR IMPLIED) OR TORT OR CONTRACT AND THE MANUFACTURER'S TOTAL LIABILITY SHALL NOT EXCEED THE PURCHASE PRICE, regardless of any advices or recommendations that may have been rendered concerning the purchase, installation or use of the equipment.

GOVERNING LAW

This agreement is made and entered in the State of Nebraska, County of Lancaster, and shall be construed and interpreted in accordance with the laws of the State of Nebraska (including the provisions of the Nebraska Uniform Commercial Code), without regard to its conflict of law's provisions. Regarding any disputes which arise hereunder, Purchaser hereby submits to the exclusive jurisdiction and venue of the District Court of Lancaster County,



CONTINUED

Nebraska or the United States District Court for the District of Nebraska. Purchaser also agrees not to bring any action or proceeding arising out of this Agreement in any other court or jurisdiction. Purchaser waives any defense of inconvenient forum to the maintenance of any action or proceeding so brought and waives any bond, surety, or other security that might be required of the Manufacturer.

RETURN POLICY

Written notice must be given to Manufacturer immediately upon discovery of any defect. All returned products must be pre-approved in writing by Manufacturer and all return shipments must be prepaid by the Purchaser Ex Works (EXW) and identified with Return Material Authorization (RMA) number issued by Manufacturer. A 35% restocking fee will be made on goods returned within 6 months of shipment.

All defective products must be returned to receive a no-cost replacement. If defective components are not returned, Purchaser must pay for replacement. This can only be subjugated by written approval from the Manufacturer.

NOTE: Upon receipt of shipment, customer is responsible for inspection of items. Most carriers require immediate notification of damage. This means inspection must be made at time of delivery and any damage must be noted on the carrier's paperwork. A signature without mention of damage is considered "clear" by the carrier and will not be covered under insurance.

Any missing or damaged goods must be reported in writing to the vendor within 30 days from date of receipt. Lack of notification within 30 days will be considered as complete and satisfactory delivery of goods.

See Terms & Conditions for details.

Thank you for choosing inExhaust as your exhaust system components solution!
For any questions, please contact us at sales@inExhaust.com.

inExhaust™ reserves the right to change the contents without notice. We do make every effort to have the most recent documents on our website. For latest revision please contact inExhaust™.

This document is also available on our website: www.inExhaust.com

All catalogs are available Online!



Can't find what you're looking for? We customize!
Contact sales@inExhaust.com for specifications and pricing.



We are proud to announce
 that our Lincoln, Nebraska
 facility achieved ISO 2001:2015
 certification on October 23, 2018!





YOUR EXHAUST SYSTEM COMPONENTS SOLUTION

inExhaust.com | 402.322.7022 | sales@inExhaust.com

©2016-2021 Innovative Exhaust Solutions, Inc.